

- Only suite A available!
- +/- 2,225 sq. ft. currently configured as office; can be converted into warehouse space
- Easily accessible site, with well and septic
- 400 amp, 3 phase power ,192 kW
- Zoning: Industrial (County of San Luis Obispo)
- \$2.50/sq. ft. month, NNN

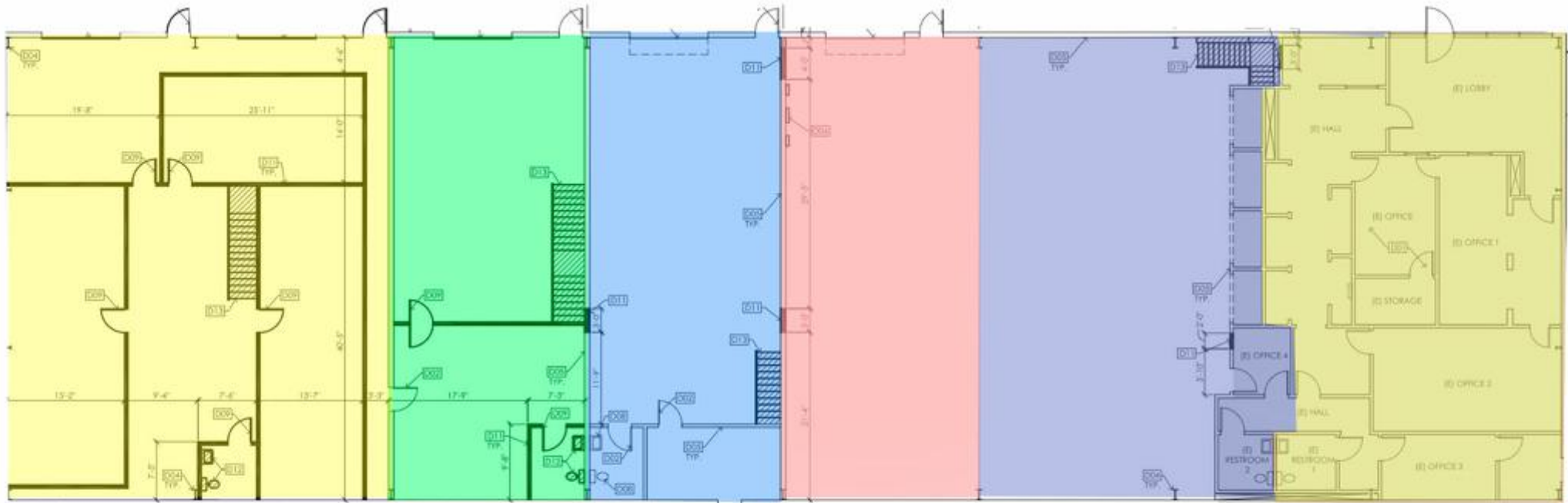



**Suites E & F**  
**3,000 SF**  
**Warehouse**  
**Leased:**  
**Tenant 1**

**Suite D**  
**1,500 SF**  
**Warehouse**  
**Leased:**  
**Tenant 2**

**Suite C**  
**1,500 SF**  
**Warehouse**  
**Leased:**  
**Tenant 3**

**Suite B2**  
**1,500 SF**  
**Warehouse**  
**Leased:**  
**Tenant 4**

**Suite B1**  
**2,275 SF**  
**Warehouse**  
**Leased:**  
**Tenant 5**

**Suite A**  
**2,225 SF**  
**Offices**  
**Available**  
**Tenant 6**